

Shore View

Portchester, Hampshire

Plot 94, The Goldcrest - £450,000

4 bedrooms | 1 bathroom | 1,044 sq ft



Specifications

- Fully fitted kitchen/dining area
- Detached garage
- Side driveway for 3 cars
- Downstairs cloakroom
- Integrated dishwasher and microwave
- Electric Vehicle charging point
- 10 year LABC warranty

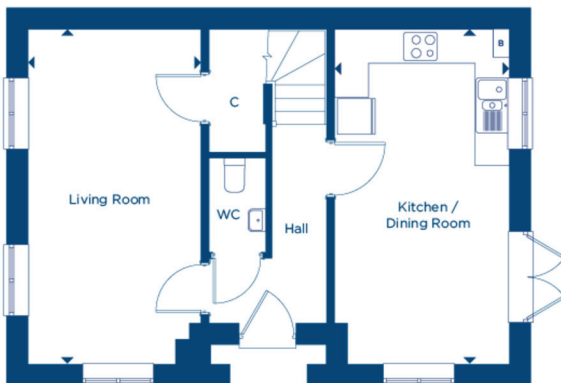

GROUND FLOOR

Living Room

5923mm x 3091mm 19' 5" x 10' 2"

Kitchen/Dining Room

5923mm x 3115mm 19' 5" x 10' 3"

Garage

5860mm x 2823mm 19' 3" x 9' 3"

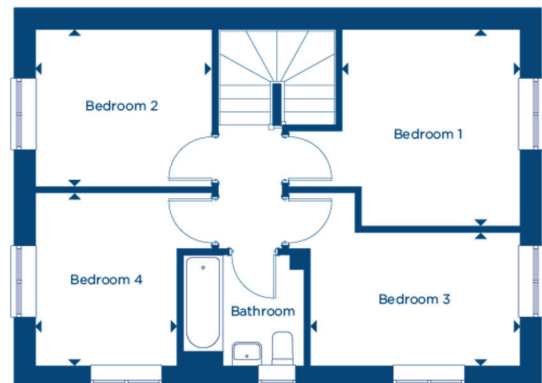

FIRST FLOOR

Bedroom 1

3483mm x 3152mm 11' 5" x 10' 4"

Bedroom 2

3129mm x 2791mm 10' 3" x 9' 2"

Bedroom 3

3706mm x 2370mm 12' 2" x 7' 9"

Bedroom 4

3061mm x 2514mm 10' 1" x 8' 3"

Bathroom

2150mm x 1740mm 7' 1" x 5' 9"

*All imagery, floor plans, and dimensions are approximate and indicative only.
Each layout and sizes may vary. Each plan may be at a different scale to the others within this brochure.*