

Maddoxford Gardens

Boorley Green, Hampshire

Plot 9, The Fieldfare - £375,000

3 bedrooms | 2 bathrooms | 901 sq ft



Specifications

- Fully fitted kitchen/dining area
- Laminated worktop with matching upstand
- En suite to master bedroom
- Off road parking for 2 vehicles
- Downstairs cloakroom
- Integrated dishwasher and microwave
- 10 year LABC warranty

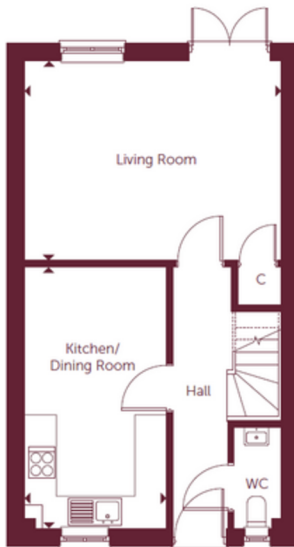

GROUND FLOOR

Living Room

4873mm x 3745mm 16' 0" x 12' 3"

Kitchen/Dining Room

5020mm x 2708mm 16' 6" x 8' 11"

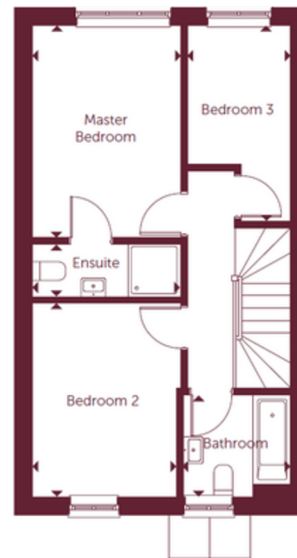

FIRST FLOOR

Master Bedroom

4042mm x 2722mm 13' 3" x 9' 1"

Guest Bedroom

3639mm x 2722mm 11' 11" x 9' 1"

Bedroom 3

2725mm x 2033mm 8' 11" x 6' 8"

Bathroom

2033mm x 1940mm 6' 8" x 6' 4"

*All imagery, floor plans, and dimensions are approximate and indicative only.
Each layout and sizes may vary. Each plan may be at a different scale to the others within this brochure.*