



Berry Way

Park Gate, Hampshire

Plot 6, The Arbutus - £365,000

3 bedrooms | 1 bathroom | 900 sq ft



Specifications

- Fully fitted kitchen area
- Open plan downstairs layout
- En suite to master bedroom
- Off road parking for 2 x vehicles
- Downstairs cloakroom
- 10 year LABC warranty



GROUND FLOOR

Living/Dining Room

4989mm x 4870mm

16' 4" x 16' 0"

Kitchen Area

3664mm x 2615mm

12' 0" x 8' 7"

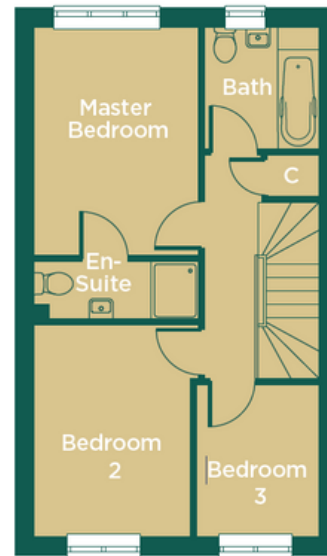

FIRST FLOOR

Master Bedroom

3943mm x 2815mm

12' 11" x 9' 3"

Guest Bedroom

3625mm x 2678mm

11' 11" x 8' 9"

Bedroom 3

2633mm x 2123mm

8' 8" x 7' 0"

Bathroom

2133mm x 1985mm

7' 0" x 6' 6"

*All imagery, floor plans, and dimensions are approximate and indicative only.
Each layout and sizes may vary. Each plan may be at a different scale to the others within this brochure.*