

LAWSONIA

Bull Lane, Waltham Chase, Southampton, SO32 2EX



SITE PLAN



LAWSONIA

Bull Lane, Waltham Chase, Southampton, SO32 2EX

Located in the rural village of Waltham Chase Lawsonia is a charming development consisting of two five bedroom detached houses, two four bedroom detached chalet bungalows and one two bedroom detached bungalow.

Designed and built with quality features and fittings, Lawsonia combines comfort and convenience.

With the nearby larger villages of Wickham and Bishops Waltham offering a wide range of shops and businesses, Winchester, Southampton and Portsmouth all within a thirteen mile radius and with excellent travel links to the M3, and M27, Lawsonia is the ideal location for the commuter who wants to live in a country setting.



PLOT 5

Dimensions

	Metres	Feet & Inches		Metres	Feet & Inches
Living Room	3.950 x 3.908	12' 12" x 12' 10"	Bathroom	2.178 x 1.733	7' 2" x 5' 8"
Kitchen/Breakfast Area	6.965 x 3.950	22' 10" x 12' 12"	Bedroom 1	5.954 x 3.063	19' 6" x 10' 1"
Dining Room	3.950 x 2.813	12' 12" x 9' 3"	En-suite 1	3.083* x 2.193*	10' 1" x 7' 2"
Study	2.178 x 1.833	7' 2" x 6' 0"	Bedroom 2	3.988 x 3.378	13' 1" x 11' 1"
WC	1.686 x 0.938	5' 6" x 3' 1"	En-suite 2	1.825 x 2.193	5' 12" x 7' 2"
			Bedroom 3	3.740* x 2.956	12' 3" x 9' 8"
			Bedroom 4	3.988* x 2.956	13' 1" x 9' 8"

* - maximum measurement

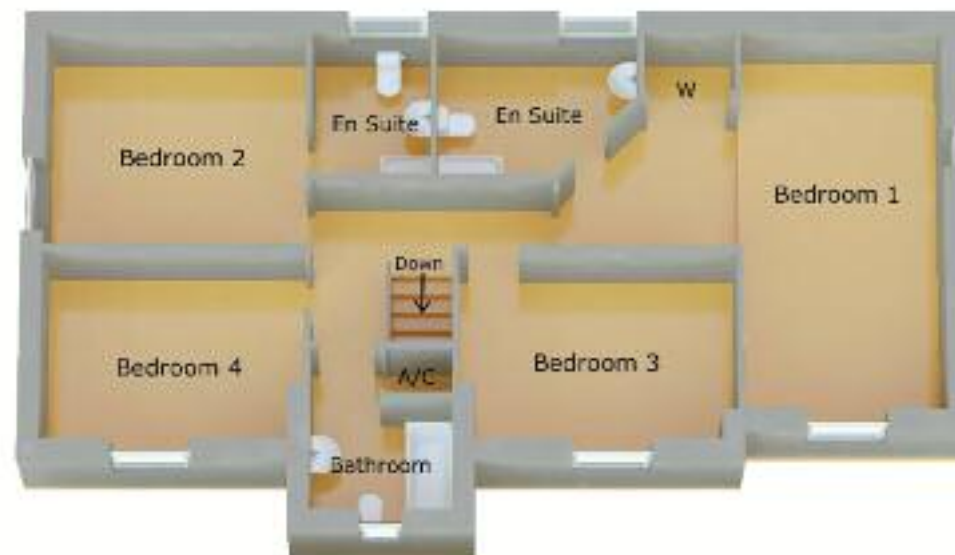

PLOT 6



Dimensions

	Metres	Feet & Inches
Living Room	4.090 x 3.813	13' 5" x 12' 6"
Kitchen/Dining Room	5.242 x 2.540	17' 2" x 8' 4"
Bathroom	2.257 x 1.708	7' 5" x 5' 7"
Bedroom 1	3.733 x 3.640	12' 3" x 11' 11"
Bedroom 2	3.963 x 2.478	13' 0" x 8' 2"



PLOT 7

Dimensions

	Metres	Feet & Inches		Metres	Feet & Inches
Living Room	4.563 x 3.950	14' 12" x 12' 12"	Bathroom	2.178 x 1.733	7' 2" x 5' 8"
Dining Room	3.950* x 2.833	12' 12" x 9' 4"	Bedroom 1	4.326 x 4.022	14' 2" x 13' 2"
Kitchen/Breakfast Area	7.465 x 3.950*	13' 0" x 12' 3"	En-suite 1	1.825 x 1.739	5' 12" x 5' 8"
Study	2.508 x 2.178	8' 3" x 7' 2"	Bedroom 2	3.950 x 3.084*	13' 0" x 10' 1"
WC	1.668 x 0.938	5' 6" x 3' 1"	Bedroom 3	3.167* x 3.950*	10' 5" x 13' 0"
			Bedroom 4	4.326* x 2.925*	14' 2" x 9' 7"

* - maximum measurement



PLOT 8

Dimensions

* - maximum measurement

	Metres	Feet & Inches		Metres	Feet & Inches
Living Room	4.880 x 3.978	16' 0" x 13' 1"	Bedroom 1	4.800 x 3.978	15' 9" x 13' 1"
Kitchen/Breakfast Area	5.988* x 4.095*	19' 8" x 13' 5"	En-suite 1	2.430 x 1.588	7' 12" x 5' 3"
Dining Room	3.978 x 3.693	13' 1" x 12' 1"	Bedroom 2	3.978 x 3.133	13' 1" x 10' 3"
Family Room	3.780 x 3.528	12' 5" x 11' 7"	En-suite 2	2.290 x 1.225	7' 6" x 4' 0"
Study	2.638 x 1.730	8' 8" x 5' 8"	Bedroom 3	4.375 x 3.220	14' 4" x 10' 7"
WC	1.588 x 0.988	5' 3" x 3' 3"	Bedroom 4	3.528 x 2.910	10' 8" x 9' 7"
			Bedroom 5	3.243 x 2.682	8' 9" x 8' 10"



PLOT 9

Dimensions

	Metres	Feet & Inches		Metres	Feet & Inches
Living Room	4.863 x 4.490	15' 11" x 14' 9"	Bedroom 1	5.270 x 3.970	17' 3" x 13' 0"
Dining Room	4.000 x 2.887	13' 1" x 9' 6"	En-suite 1	2.076* x 2.119*	6' 11" x 4' 4"
Kitchen/Family Room	5.679 x 3.978	18' 8" x 13' 1"	Bedroom 2	5.115* x 2.902*	16' 9" x 9' 6"
Utility	1.833 x 1.683	6' 0" x 5' 6"	En-suite 2	2.076* x 1.811*	4' 2" x 5' 11"
Study	3.640 x 2.858	11' 11" x 9' 5"	Bedroom 3	2.894 x 2.888	9' 6" x 9' 6"
WC	1.033 x 1.738	3' 5" x 5' 8"	Bedroom 4	3.363 x 2.775	11' 0" x 9' 1"
			Bedroom 5	2.768 x 2.238	9' 1" x 7' 4"
			Bathroom	2.200 x 1.708	7' 3" x 5' 7"

* - maximum measurement



LAWSONIA

Bull Lane, Waltham Chase, Southampton, SO32 2EX

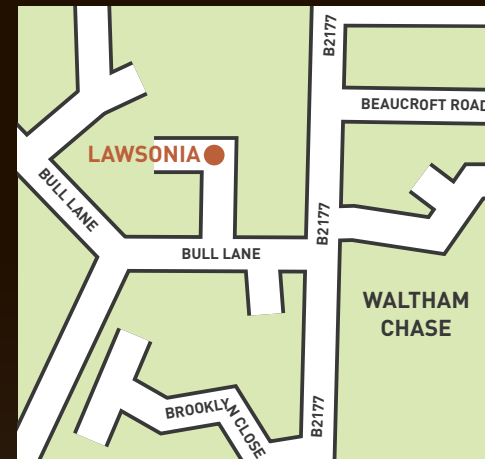

- 10 Year NHBC Buildmark warranty
- PVCu double glazed windows
- Gas central heating
- Choice of fitted kitchen*
- Choice of tiling to bathroom, en suite & cloakroom*
- Integrated appliances in kitchen to include hob, extractor, oven, washer / dryer, dishwasher #
- Oak veneered doors with polished chrome door furniture
- Luxury white bathroom suites
- Mains wired smoke alarms

* Depending on stage of construction # On selected plots, ask for details

DISCLAIMER

The details included in this brochure are intended to give a general indication of the proposed development and floor layouts, and are believed to be correct at the time of printing.

The contents of this brochure shall not form any part or be deemed to form any part of any contract or be a representation included in any such contract.

Please note: Plans are not to scale and are given for guidance purposes only. All computer generated images are used for the proposed housing only. The setting, imagery, landscaping, external colours and fenestration may differ.

All measurements are taken from architectural drawings and are for guidance purposes only. Whilst every effort has been taken to ensure their accuracy, this cannot be guaranteed.

LOVE IT. LIVE IT.

0845 4507714
www.foremanhomes.co.uk



Foreman
Homes